



Ezi-SERVO HS is a unit product that combines a Hollow Shaft Motor and Ezi-SERVO, which is a Closed Loop System. There is a hole in the motor shaft, so it can be used for inserting cable or pipe, which provides design flexibility and convenience.

Their main characteristics are :

- Hollow Shaft Motor with High Resolution Encoder
- Closed Loop System
- High Precision Position Control
- High Torque, Low Temperature
- EtherCAT, Ethernet, CC-Link Support

Technical Data

Motor Model	Number of phases	Current	Holding Torque	Rotor Inertia	Weights	Length (L)	Permissible Overhung Load (Distance from end of shaft)				
							3mm	8mm	13mm	18mm	
Units	-	A	Nm	g.cm ²	g	mm	N				
HSE-20	20M	2	0,5	0,014	2,45	80	27,2	18	30	-	-
	20L	2	0,5	0,02	3,7	100	38,1	18	30	-	-
HSE-28	28S	2	1,0	0,053	6,23	120	33,35	38	53	-	-
	28M	2	1,0	0,117	11	160	45	38	53	-	-
HSE-35	35M	2	1,0	0,19	17	180	33,6	22	26	33	46
	35L	2	1,0	0,36	28	230	45,6	22	26	33	46
HSE-42	42S	2	1,0	0,31	30,3	260	34,1	22	26	33	46
	42L	2	2,5	0,56	58,1	360	48,1	22	26	33	46
HSE-56	56S	2	2,0	1,2	147,1	480	45	52	65	85	123
	56M	2	2,5	2,1	281,2	800	65	52	65	85	123
HSE-86	86M	2	3,0	4,5	1265,3	2400	76	270	300	350	400

SPECIFICATIONS

SPECIFICATIONS OF MOTOR

Drive Method	BI-POLAR
Permissible Thrust Load (N)	Lower than motor weight
Insulation Resistance (Mohm)	100 MIN.(at 500 VDC)
Insulation Class	CLASS B(130°C)
Operating Temperature (°C)	0 to 55

DRAWING

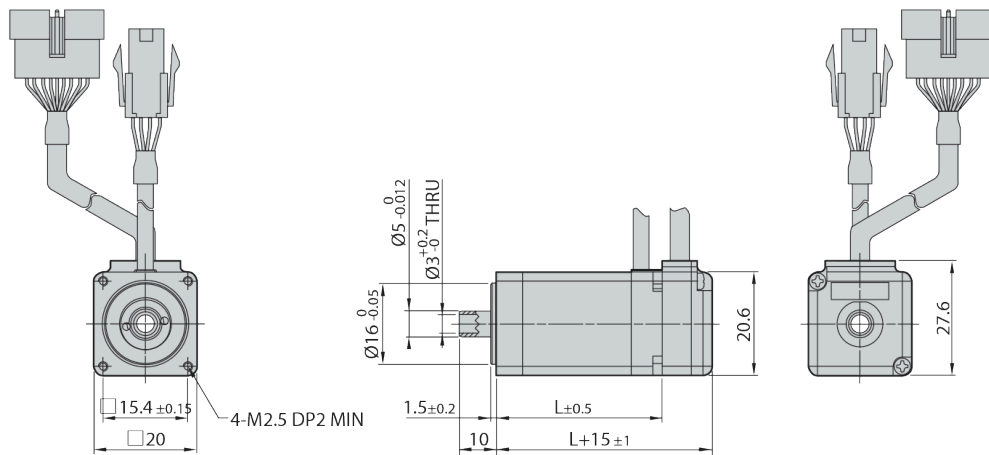

Dimensions	L
HSE-20M	27,2
HSE-20L	38,1

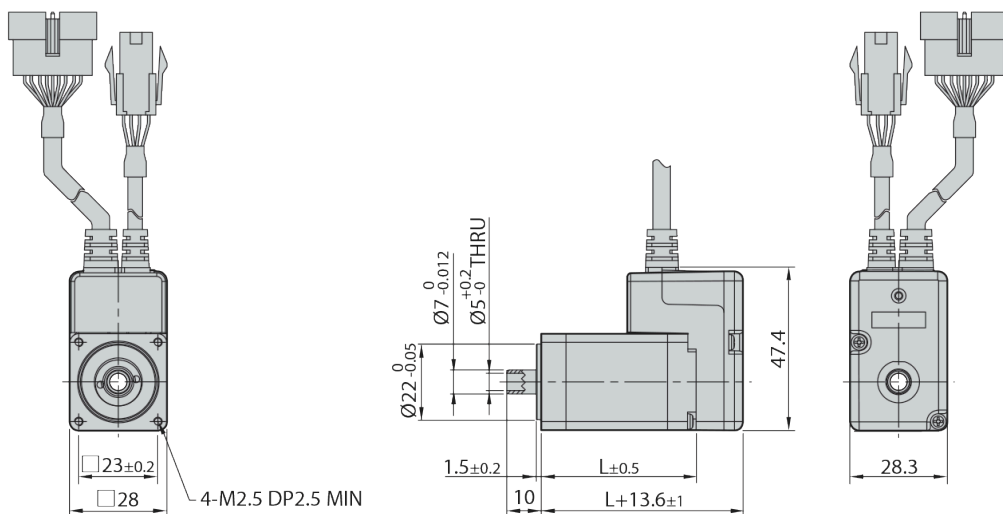

Dimensions	L
HSE-28SM	33,35
HSE-28MM	45

DRAWING

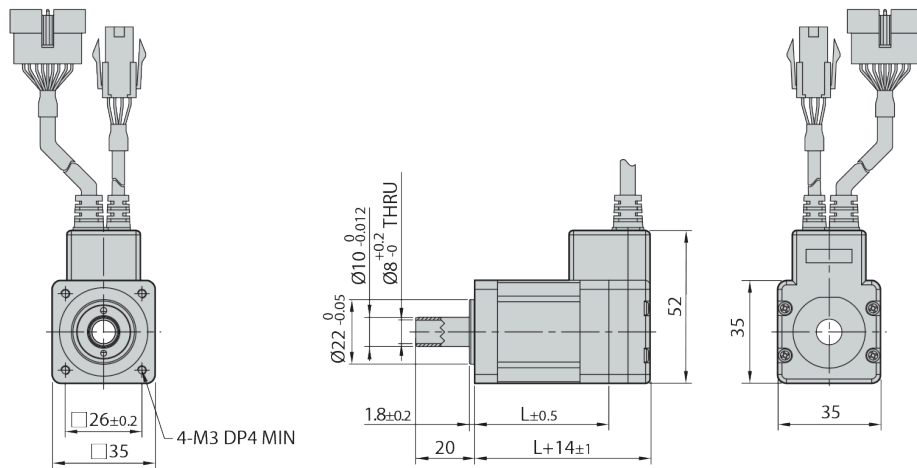

Dimensions	L
HSE-35MM	33,6
HSE-35LM	45,6

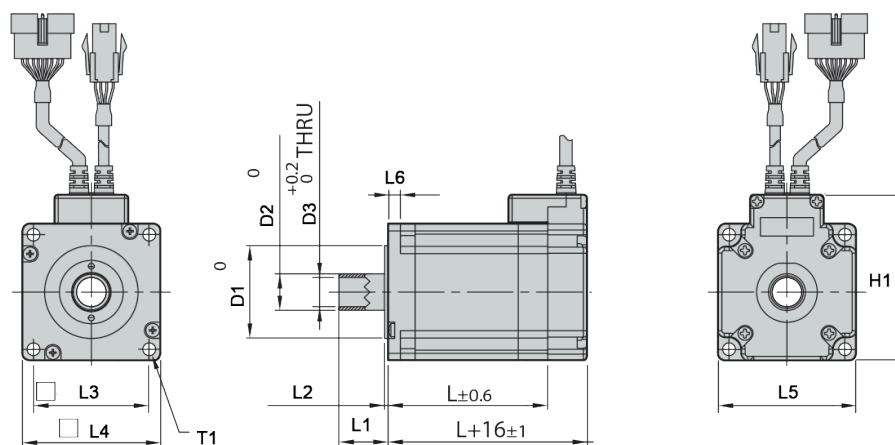

Dimensions	L	L1	L2	L3	L4	L5	L6	H1	D1	D2	D3	T1
HSE-42S	34,1	20	1,8±0,2	31±0,2	42,2	42	-	59	Ø22-0,05	Ø10-0,012	Ø8	4-M3 DP4 MIN
HSE-42L	48,1											
HSE-56S	45	20	1,5±0,2	47,14±0,25	56,2	56	5	68,1	Ø38,1-0,05	Ø15-0,012	Ø12	4-Ø5,2 THRU
HSE-56M	65											
HSE-86M	76	20	1,5±0,2	69,3±0,25	86	-	10	96	Ø73-0,05	Ø20-0,012	Ø16	4-Ø6,5

PART NUMBER COMPOSITION

Ezi-SERVO HS ST-56L-A-X



1 Drive Series Type

EC : EtherCAT
 EC-MI : EtherCAT Mini Type
 EC-4X : EtherCAT 4 axes
 PE : Plus Ethernet
 PE-MI : Plus Ethernet Mini Type
 CL : CC-Link
 ST : Pulse Input
 MI : Pulse Input Mini Type

2 Motor Flange size

20 : 20mm
 28 : 28mm
 35 : 35mm
 42 : 42mm
 56 : 56mm
 86 : 86mm

3 Motor Length

S : Small
 M : Medium
 L : Large

4 Encoder Resolution

A : 10,000[ppr]
 B : 20,000[ppr]
 D : 16,000[ppr]
 F : 4,000[ppr]

5 User Code

In accordance with our policy of continual product improvement, A2V reserves the right to amend the specification of these products without prior notification